



SIMPLY PRODUCTIVE  
WITH CONNECTIVITY.



CORDLESS PRECISION FASTENING SYSTEMS

any or application, you can count on Ingersoll Rand as a trusted partner to help

## KEY DESIGN



### EASILY IMPLEMENT CHANGE

selection, training  
ation costs  
e, ergonomic  
order, fast

- Easy line integration and rebalancing
- Multiple product options
- Connectivity options enable fast programming



### MEET YOUR REQUIREMENTS

- Performance that optimizes your productivity
- Durable designs, lower cost of ownership
- Advanced diagnostics identify problems and enhance safety



## SIMPLE

- Multi-function display module for quick setup and feedback
- Compact, lightweight and ergonomically balanced so the operator can work without restraints
- The intuitive INSIGHT Connect app will help you stay productive & mobile on the plant floor via Bluetooth or wired connection.

## FLEXIBLE

- Provides up to 32 fully programmable configurations on a single tool, reducing costs and workspace clutter
- Fast and intuitive programming makes the tool easily adaptable to any needed changes on your assembly line
- Cordless and portable, allowing for effortless movement around your facility

## CAPABLE

- At the heart of every tool is the closed-loop transducer control that delivers precise torque and accurate, traceable results
- Available in a variety of configurations, including pistol grip, angle wrench, multiplied, and ETS
- Wireless & Bluetooth communication options enable flexible line integration, remote monitoring and simple system programming across a plant-wide network
- Manage cycle data, control the process, receive system status alerts and implement configuration adjustments in real time with INSIGHTqcx™ using

QX Connect Series™  
Precision Screwdriver

QX Series  
1,000 Nm

The QX Connect Series™ line of products give you closed-loop control process, and the ease of mobility with different connectivity options for programmable tightening strategies to deliver higher quality fastened joints is unmatched by other solutions. The diversity of the QX Series™ lineup offers a capable solution for any fastening need.



FEATURES	QXFN		QXFD		QXBN		QXBD	
	Icon	Included	Icon	Included	Icon	Included	Icon	Included
Display & Keypad		Included		Included		Included		Included
Bluetooth						Included		Included
QXW Limitless Wireless Radio Connectivity to INSIGHT <sup>qx</sup>								
Wireless Zigbee 802.15.4 Capability								
Programmable with INSIGHT Connect via Bluetooth						Included		Included
Programmable with INSIGHT Connect and INSIGHT qcx via USB		Included		Included		Included		Included
ETS Optional		Included		Included		Included		Included
Number of PSETs		32*		32*		32		32

**Symbol Key:**  
 USB symbol = USB Communication  
 Bluetooth symbol = Bluetooth Communication  
 Wifi Symbol = Zigbee Communication

**All models available in the following configurations:**  
 QXF-USB Communication, No Wireless Functionality  
 QXB-Bluetooth Only  
 QXX- 802.15.4 Zigbee & Bluetooth  
 QXW-Wifi

... wireless communication and can only be programmed via USB using the



... measured torque or angle results to the operator. The QXB models further add



... e measurement  
... eed and degrees

... g the INSIGHT

... reen, yellow and

... ntenance alarms

... shooting and

... cessible via the

... display option

... y tool models



# 32.5

## FEATURES

- Flexibility to utilize the same tool on multiple applications
- Program 32 PSETs configurations into one tool
- Visual torque validation on display
- Transducerized for precise torque measurement
- Closed-loop control of torque, speed and degrees of rotation
- Flexible Connectivity options with Bluetooth for simple programming using the INSIGHT Connect app or back of tool programming.
- Visual operator feedback using green, yellow and red lights
- Programmable preventative maintenance alarms
- Maintenance indicator for troubleshooting and diagnostics
- 1200 cycles of data storage



Utilizing Zigbee wireless connectivity & tool programming may also utilize the



Integration into plant wide productivity and control data collection capability transmission of tightening data Ethernet, Fieldbus or I/O on multiple applications one tool way e measurement eed and degrees ing display screen and green tenance alarms shooting and diagnostics



QX Connect Series™ platform, with less the torque reaction.

### What is ETS (Ergonomic Tightening System)

ETS stands for "Ergonomic Tightening System". QX + ETS delivers all the performance of the standard QX Series™ precision fastening tools, with an improved ergonomic design to reduce the average amount of force experienced by the operator during the tightening process.



QX + ETS reduces average reaction force experienced by the QX Series™ user up to

**↓ 63%**

When ETS is Active, the operator's arm movement is limited to a series of smaller movements instead of one large movement.



### FEATURES

- Ergonomically enhanced motor control algorithm significantly reduces the average force experienced by the operator during the tightening process
- Red foot label provides clear indication of ETS tool identity vs standard QX tool
- Continuously flashing purple light above keypad provides operator assurance that ETS is ACTIVE
- All the capability of the QX platform, without the torque reaction
- Common software and battery platform for simple integration
- ETS features are available for all QX Connect models and available in pistol grip, low torque angle and high torque angle
- Onboard 'pulse' counter supports proper optimization and application of ETS tools on ideal applications (10 pulses or less per cycle)



### SIMPLE SETUP

In addition to standard direct drive mode, each tool configuration can be independently programmed to

**Performance Mode** is the best all-purpose

...s™ has been instrumental  
control of their fastening  
...le, and capable performance.  
X Limitless platform we're adding  
...ant' to the bottom line. Dual-  
...eliver a seamless, uninterrupted  
communication range than other  
...er.

## Control • Confidently Secure

- Security Authentication
- Extended Coverage on Mesh Networks



## CONNECTIVITY

The QX Limitless platform enhances seamless, plant-wide connectivity across a broader range where access points share the same SSID and password. Incorporating dual band communication technology, the system helps to eliminate communication breakdowns in high-traffic work zones to ensure no loss in production.

- Dual Band Communication seamlessly switches between 2.4 and 5 Ghz Band
- Reduces Limitation of Communication distance between Tools and Controller

## CONFIDENTLY SECURE

QX Limitless delivers greater confidence, connecting with the devices you need just as importantly, NOT the ones you don't need. As a single product, it complies multiple IT cybersecurity regulations, increasing data protection, restricting access non-authorized devices, and providing ease of adoption across more systems.

## COMPLETE CONTROL

The QX Limitless limits your hardware footprint by connecting more tools on a single network. This fast, reliable system delivers greater control over more tools, delivering quick transfer between devices and reducing installation costs. Plus, your tools are ready to cycle much sooner, ensuring increased production efficiency.

- Connect Up to 10 Tools with INSIGHTqcx™ Controller
- Upto 40% reduction in Hardware footprint
- Faster data Transfer

## SPECIFICATIONS

Product Family		QXWD
Torque Range		0.8-80 Nm
Tool Configuration		Pistol and Angle
Wireless Communication		WLAN + ZigBee + BLE
Band		2.4 and 5 Ghz (Dual Band)
Security Authentication		WPA/WPA2, EAP-TLS, EAP TTLS, PEAP
Ergonomic Tightening System		Optional



## Plant Network

- Program 32 Configuration on one tool
- Visual Torque validation on display
- With INSIGHTqcx™ complete integration to plant wide Ethernet network, for increased productivity and control

Multiplier is world-class in quality, control and programmable configurations



allowing for quick setup and tool such as torque, angle and of tools needed when multiple



shooting and diagnostics make the tool easily adaptable available

variety of reaction arms for different applications. Reaction arms are available in both ending the on the size of the gearbox.

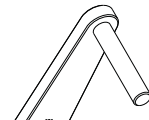
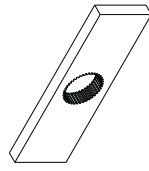
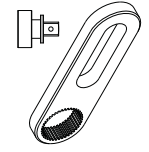

Plate and pin multiple



Double-sided



Sliding slave kit (multiple)

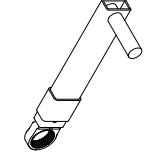

Sliding peg and yoke assembly (multiple lengths)

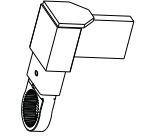

Sliding yoke, paddle and yoke assembly

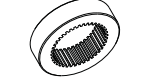

Blank welding ring

mobile and in control of your any Ingersoll Rand® QX Connect for additional technical training permissions or a laptop computer or tablet, operators can use the torque and angle control configuration and angle control configuration transducerized tools.



Once installed, the INSGHT™ Connect app can operate offline, so it functions in large facilities or other locations where Internet signal loss may be a problem, reducing downtime and maximizing ease of use. The INSGHT Connect App is a perfect companion to complement QX Connect Series™ tools\*. With Bluetooth capability, the INSGHT Connect App can communicate wirelessly via Bluetooth with the QX Connect tools.



You can quickly perform key tasks with your mobile device, including:

**SIMPLE**

- Common Setting & General Tool Setup
- Multiple Language Support
- Retrieve Cycle Log and Share via Email
- Audit Logs
- Error Codes with Description

**FLEXIBLE**

- Program All Standard QX Platform Tool
- Clone- Back Up and Restore
- Save and Load Configurations
- Firmware Update
- Virtual tool programming

er is the perfect solution to simply increase the flexibility of your QX pistol  
 erages the closed-loop capability of the QX tool to the most unique applications.  
 meet the requirements of applications where restricted access requires a custom  
 on applications requiring a special head adapter, include assembling aircraft  
 ars and trucks.



**SIMPLE**

Ready made  
 and easy to  
 install

**FLEXIBLE**

Use your QX pistol  
 grip tool for unique  
 applications

**CAPABLE**

Employ closed-loop  
 control capabilities on  
 speciality applications

understanding the fastening process doesn't have to be complex  
 INSIGHTqcx™ is different, by design. This cordless controller is  
 integrate, while providing a common platform to meet your ass

With the new Multi Tools Controller (MTC) software option, you  
 up to 6 tools with just one INSIGHTqcx™ controller. Ingersoll R  
 QX Series™ & INSIGHTqcx™ MTC controller provides some of  
 market, with one of the lowest total costs of ownership & cost t



**EXPERTISE  
 NOT  
 REQUIRED**

**WHAT  
 DOES  
 THIS MEAN  
 TO ME?**

- Save on selection, training and installation costs
- Reduce errors and downtime
- Remove user dependencies

**HOW DOES  
 INGERSOLL  
 RAND PROVIDE  
 VALUE?**

- Intuitive, visual programming interface
- Plug and play accessories and protocols
- Integrated backup and recovery
- Bundled controller options
- Easy Wireless Pairing (up to 6 tools with MTC option)
- Tightening configurations can be shared between tools (MTC)



**EASILY  
 IMPLEMENT  
 CHANGE**

- Reduce line rebalancing costs
- Easy line integration
- Remove device dependency

- Web based programming use any operating system via any browser
- Meets current industry communication needs
- Integrated logic controls
- Easy hardware and software upgrades
- Onboard wireless energy scan



needs. QX Precision Fastening Systems are compatible with a variety of plug and play accessories for your manufacturing line.

**ACCESSORIES FOR ANY APPLICATION**

- Battery chargers
- Battery packs
- Boots
- Bit selector trays
- Socket selector trays
- Suspension bales
- Auxiliary handles
- Selector tray cables



**IQV40™ Series 40V,  
2.5Ah - Battery Charger  
BC1161**



**IQV20™ Series 20V  
Battery Charger  
BC1121**



**IQV40™ Series 40V,  
2.5Ah - Lithium-Ion  
Battery Pack**



**IQV20™ Series 20V, 5.0Ahr -  
Lithium-Ion Battery  
BL2022**



**Socket Selector  
Tray**



**Bit Selector Tray**



**Boot**



**Spring  
Balancer**



**Torque Tester**



**Selector Tray  
Cables**



**Auxiliary  
Handle**



Integrated carrying handle



Holds 500,000 records for results & trace



7-in full color touch screen



- System indicators**
- Factory connection
  - Wireless connection
  - Link status
  - Fault detected

SKU#	Tools to Pair
MTC-SW-OPT2	2
MTC-SW-OPT4	4
MTC-SW-OPT6	6
MTC-SW-OPT10	10

**MTC OPTIONS**

- Up to 6 tools per controller
- Unlock Multi tool dashboard view
- Upgradeable software
- Backwards compatibility with INSIGHTqcx™ & QX™ tools

Controller model info on page 23



**SIMPLE**



**FLEXIBLE**



**CAPABLE**



Comprehensive Product Specifications											
Product ID	Model Name	Weight lbs (kg)	Length in (mm)	to center distance in (mm)	Performance Metrics			Connectivity & Compatibility			
					Torque in-lbs	Torque Nm	rpm	Weight lbs (kg)	Length in (mm)	to center distance in (mm)	Voltage
Pistol Series	Model: Pistol										
	QXBN2PT004PQ04	2 (0.91)	8.48 (215.4)	0.8-1.0 (20.3-26.0)	20V	1/4" Quick Change	Via USB Cable	Bluetooth Only	YES	YES	
	QXBN2PT004PS04	2 (0.91)	8.2 (208.3)	0.8-1.0 (20.3-26.0)	20V	1/4" Square	Via USB Cable	Bluetooth Only	YES	YES	
	QXBN2PT004PS06	2 (0.91)	8.35 (212)	0.8-1.0 (20.3-26.0)	20V	3/8" Square	Via USB Cable	Bluetooth Only	YES	YES	
	QXBN2PT008PQ04	2 (0.91)	8.48 (215.4)	0.8-1.0 (20.3-26.0)	20V	1/4" Quick Change	Via USB Cable	Bluetooth Only	YES	YES	
	QXBN2PT008PS04	2 (0.91)	8.2 (208.3)	0.8-1.0 (20.3-26.0)	20V	1/4" Square	Via USB Cable	Bluetooth Only	YES	YES	
	QXBN2PT008PS06	2 (0.91)	8.35 (212)	0.8-1.0 (20.3-26.0)	20V	3/8" Square	Via USB Cable	Bluetooth Only	YES	YES	
	QXBN2PT012PQ04	2 (0.91)	8.48 (215.4)	0.8-1.0 (20.3-26.0)	20V	1/4" Quick Change	Via USB Cable	Bluetooth Only	YES	YES	
	QXBN2PT012PS04	2 (0.91)	8.2 (208.3)	0.8-1.0 (20.3-26.0)	20V	1/4" Square	Via USB Cable	Bluetooth Only	YES	YES	
	QXBN2PT012PS06	2 (0.91)	8.35 (212)	0.8-1.0 (20.3-26.0)	20V	3/8" Square	Via USB Cable	Bluetooth Only	YES	YES	
Angle Series	Model: Angle										
	QXBN2AT005PQ04	3 (1.14)	21.73 (552)	0.36 (9.2)	20V	1/4" Quick Change	Via USB Cable	Bluetooth Only	YES	YES	
	QXBN2AT010PS06	2.6 (1.18)	20.67 (525)	0.49 (12.5)	20V	3/8" Square	Via USB Cable	Bluetooth Only	YES	YES	
	QXBN2AT015PS06	2.6 (1.18)	20.67 (525)	0.49 (12.5)	20V	3/8" Square	Via USB Cable	Bluetooth Only	YES	YES	
	QXBN2AT018PQ04	2.8 (1.27)	24.34 (542)	0.51 (13)	20V	1/4" Quick Change	Via USB Cable	Bluetooth Only	YES	YES	
	QXBN2AT018PS06	2.8 (1.27)	24.34 (542)	0.51 (13)	20V	3/8" Square	Via USB Cable	Bluetooth Only	YES	YES	
	QXBN2AT027PS06	3.7 (1.68)	21.73 (552)	0.67 (17)	20V	3/8" Square	Via USB Cable	Bluetooth Only	YES	YES	
	QXBN5AT020PS06	5 (2.04)	22.74 (577.7)	0.52 (13.1)	40V	3/8" Square	Via USB Cable	Bluetooth Only	YES	YES	
	QXBN5AT030PS06	4.8 (2.18)	22.91 (581.8)	0.68 (17.2)	40V	3/8" Square	Via USB Cable	Bluetooth Only	YES	YES	
	QXBN5AT030PS08	4.8 (2.18)	22.91 (581.8)	0.68 (17.2)	40V	1/2" Square	Via USB Cable	Bluetooth Only	YES	YES	
OXFD Series	Model: OXFD										
	QXBN5AT035PS06	4.8 (2.18)	22.91 (581.8)	0.68 (17.2)	40V	3/8" Square	Via USB Cable	Bluetooth Only	YES	YES	
	QXBN5AT035PS08	4.8 (2.18)	22.91 (581.8)	0.68 (17.2)	40V	1/2" Square	Via USB Cable	Bluetooth Only	YES	YES	
	QXBN5AT040PS08	5 (2.27)	23.07 (586.1)	0.85 (21.6)	40V	1/2" Square	Via USB Cable	Bluetooth Only	YES	YES	
	QXBN5AT080PS08	5 (2.27)	23.07 (586.1)	0.85 (21.6)	40V	1/2" Square	Via USB Cable	Bluetooth Only	YES	YES	
	QXFD: Pistol										
	QXFD2PT004PQ04	7-35 (0.8-4)	1500	2.0 (0.91)	8.48 (215.4)	0.8-1.0 (20.3-26.0)	20V	1/4" Quick Change	Via USB Cable	Bluetooth Only	YES
	QXFD2PT004PS04	7-35 (0.8-4)	1500	2.0 (0.91)	8.2 (208.3)	0.8-1.0 (20.3-26.0)	20V	1/4" Square	Via USB Cable	Bluetooth Only	YES
	QXFD2PT004PS06	7-35 (0.8-4)	1500	2.0 (0.91)	8.35 (212)	0.8-1.0 (20.3-26.0)	20V	3/8" Square	Via USB Cable	Bluetooth Only	YES
	QXFD2PT008PQ04	14-70 (1.6-8)	1150	2.0 (0.91)	8.48 (215.4)	0.8-1.0 (20.3-26.0)	20V	1/4" Quick Change	Via USB Cable	Bluetooth Only	YES
QXFD2PT008PS04	14-70 (1.6-8)	1150	2.0 (0.91)	8.2 (208.3)	0.8-1.0 (20.3-26.0)	20V	1/4" Square	Via USB Cable	Bluetooth Only	YES	
QXFD2PT008PS06	14-70 (1.6-8)	1150	2.0 (0.91)	8.35 (212)	0.8-1.0 (20.3-26.0)	20V	3/8" Square	Via USB Cable	Bluetooth Only	YES	
QXFD2PT012PQ04	21-106 (2.4-12)	750	2.0 (0.91)	8.48 (215.4)	0.8-1.0 (20.3-26.0)	20V	1/4" Quick Change	Via USB Cable	Bluetooth Only	YES	
QXFD2PT012PS04	21-106 (2.4-12)	750	2.0 (0.91)	8.2 (208.3)	0.8-1.0 (20.3-26.0)	20V	1/4" Square	Via USB Cable	Bluetooth Only	YES	
QXFD2PT012PS06	21-106 (2.4-12)	750	2.0 (0.91)	8.35 (212)	0.8-1.0 (20.3-26.0)	20V	3/8" Square	Via USB Cable	Bluetooth Only	YES	
QXFD2PT018PQ04	32-159 (3.6-18)	500	2.0 (0.91)	8.48 (215.4)	0.8-1.0 (20.3-26.0)	20V	1/4" Quick Change	Via USB Cable	Bluetooth Only	YES	
QXFD2PT018PS06	32-159 (3.6-18)	500	2.0 (0.91)	8.35 (212)	0.8-1.0 (20.3-26.0)	20V	3/8" Square	Via USB Cable	Bluetooth Only	YES	
QXFD2AT005PQ04	9-44 (1.0-5)	1213	2.5 (1.14)	21.73 (552)	0.36 (9.2)	20V	1/4" Quick Change	Via USB Cable	Bluetooth Only	YES	
QXFD2AT010PS06	18-89 (2.0-10)	936	2.6 (1.18)	20.67 (525)	0.49 (12.5)	20V	3/8" Square	Via USB Cable	Bluetooth Only	YES	
QXFD2AT015PS06	27-133 (3.0-15)	600	2.6 (1.18)	20.67 (525)	0.49 (12.5)	20V	3/8" Square	Via USB Cable	Bluetooth Only	YES	
QXFD2AT018PQ04	32-159 (3.6-18)	500	2.8 (1.27)	24.34 (542)	0.51 (13)	20V	1/4" Quick Change	Via USB Cable	Bluetooth Only	YES	
QXFD2AT018PS06	32-159 (3.6-18)	500	2.8 (1.27)	24.34 (542)	0.51 (13)	20V	3/8" Square	Via USB Cable	Bluetooth Only	YES	
QXFD2AT027PS06	48-239 (5.4-27)	330	3.7 (1.68)	21.73 (552)	0.67 (17)	20V	3/8" Square	Via USB Cable	Bluetooth Only	YES	
QXFD5AT020PS06	2.95-14.75 (4.0-20)	1045	4.5 (2.04)	22.74 (577.7)	0.52 (13.1)	40V	3/8" Square	Via USB Cable	Bluetooth Only	YES	
QXFD5AT030PS06	4.40-22.10 (6.0-30)	775	4.8 (2.18)	22.91 (581.8)	0.68 (17.2)	40V	3/8" Square	Via USB Cable	Bluetooth Only	YES	
QXFD5AT030PS08	4.40-22.10 (6.0-30)	775	4.8 (2.18)	22.91 (581.8)	0.68 (17.2)	40V	1/2" Square	Via USB Cable	Bluetooth Only	YES	
QXFD5AT035PS06	5.20-25.80 (7.0-35)	640	4.8 (2.18)	22.91 (581.8)	0.68 (17.2)	40V	3/8" Square	Via USB Cable	Bluetooth Only	YES	
QXFD5AT035PS08	5.20-25.80 (7.0-35)	640	4.8 (2.18)	22.91 (581.8)	0.68 (17.2)	40V	1/2" Square	Via USB Cable	Bluetooth Only	YES	
QXFD5AT040PS08	5.90-29.50 (8.0-40)	545	5.0 (2.27)	23.07 (586.1)	0.85 (21.6)	40V	1/2" Square	Via USB Cable	Bluetooth Only	YES	
QXFD5AT080PS08	8.80-59.0 (12.0-80)	375	5.0 (2.27)	23.07 (586.1)	0.85 (21.6)	40V	1/2" Square	Via USB Cable	Bluetooth Only	YES	
OXFD: Pistol	Model: OXFD										
	QXFD2PT004PQ04	7-35 (0.8-4)	1500	2.0 (0.91)	8.48 (215.4)	0.8-1.0 (20.3-26.0)	20V	1/4" Quick Change	Via USB Cable	Bluetooth Only	YES
	QXFD2PT004PS04	7-35 (0.8-4)	1500	2.0 (0.91)	8.2 (208.3)	0.8-1.0 (20.3-26.0)	20V	1/4" Square	Via USB Cable	Bluetooth Only	YES
	QXFD2PT004PS06	7-35 (0.8-4)	1500	2.0 (0.91)	8.35 (212)	0.8-1.0 (20.3-26.0)	20V	3/8" Square	Via USB Cable	Bluetooth Only	YES
	QXFD2PT008PQ04	14-70 (1.6-8)	1150	2.0 (0.91)	8.48 (215.4)	0.8-1.0 (20.3-26.0)	20V	1/4" Quick Change	Via USB Cable	Bluetooth Only	YES
	QXFD2PT008PS04	14-70 (1.6-8)	1150	2.0 (0.91)	8.2 (208.3)	0.8-1.0 (20.3-26.0)	20V	1/4" Square	Via USB Cable	Bluetooth Only	YES
	QXFD2PT008PS06	14-70 (1.6-8)	1150	2.0 (0.91)	8.35 (212)	0.8-1.0 (20.3-26.0)	20V	3/8" Square	Via USB Cable	Bluetooth Only	YES
	QXFD2PT012PQ04	21-106 (2.4-12)	750	2.0 (0.91)	8.48 (215.4)	0.8-1.0 (20.3-26.0)	20V	1/4" Quick Change	Via USB Cable	Bluetooth Only	YES
	QXFD2PT012PS04	21-106 (2.4-12)	750	2.0 (0.91)	8.2 (208.3)	0.8-1.0 (20.3-26.0)	20V	1/4" Square	Via USB Cable	Bluetooth Only	YES
	QXFD2PT012PS06	21-106 (2.4-12)	750	2.0 (0.91)	8.35 (212)	0.8-1.0 (20.3-26.0)	20V	3/8" Square	Via USB Cable	Bluetooth Only	YES
QXFD2PT018PQ04	32-159 (3.6-18)	500	2.0 (0.91)	8.48 (215.4)	0.8-1.0 (20.3-26.0)	20V	1/4" Quick Change	Via USB Cable	Bluetooth Only	YES	
QXFD2PT018PS06	32-159 (3.6-18)	500	2.0 (0.91)	8.35 (212)	0.8-1.0 (20.3-26.0)	20V	3/8" Square	Via USB Cable	Bluetooth Only	YES	
QXFD2AT005PQ04	9-44 (1.0-5)	1213	2.5 (1.14)	21.73 (552)	0.36 (9.2)	20V	1/4" Quick Change	Via USB Cable	Bluetooth Only	YES	
QXFD2AT010PS06	18-89 (2.0-10)	936	2.6 (1.18)	20.67 (525)	0.49 (12.5)	20V	3/8" Square	Via USB Cable	Bluetooth Only	YES	
QXFD2AT015PS06	27-133 (3.0-15)	600	2.6 (1.18)	20.67 (525)	0.49 (12.5)	20V	3/8" Square	Via USB Cable	Bluetooth Only	YES	
QXFD2AT018PQ04	32-159 (3.6-18)	500	2.8 (1.27)	24.34 (542)	0.51 (13)	20V	1/4" Quick Change	Via USB Cable	Bluetooth Only	YES	
QXFD2AT018PS06	32-159 (3.6-18)	500	2.8 (1.27)	24.34 (542)	0.51 (13)	20V	3/8" Square	Via USB Cable	Bluetooth Only	YES	
QXFD2AT027PS06	48-239 (5.4-27)	330	3.7 (1.68)	21.73 (552)	0.67 (17)	20V	3/8" Square	Via USB Cable	Bluetooth Only	YES	
QXFD5AT020PS06	2.95-14.75 (4.0-20)	1045	4.5 (2.04)	22.74 (577.7)	0.52 (13.1)	40V	3/8" Square	Via USB Cable	Bluetooth Only	YES	
QXFD5AT030PS06	4.40-22.10 (6.0-30)	775	4.8 (2.18)	22.91 (581.8)	0.68 (17.2)	40V	3/8" Square	Via USB Cable	Bluetooth Only	YES	
QXFD5AT030PS08	4.40-22.10 (6.0-30)	775	4.8 (2.18)	22.91 (581.8)	0.68 (17.2)	40V	1/2" Square	Via USB Cable	Bluetooth Only	YES	
QXFD5AT035PS06	5.20-25.80 (7.0-35)	640	4.8 (2.18)	22.91 (581.8)	0.68 (17.2)	40V	3/8" Square	Via USB Cable	Bluetooth Only	YES	
QXFD5AT035PS08	5.20-25.80 (7.0-35)	640	4.8 (2.18)	22.91 (581.8)	0.68 (17.2)	40V	1/2" Square	Via USB Cable	Bluetooth Only	YES	



Model	Series	Display	Hardw	Optic
QXXN2PT012EQ04	QCXD11	Display	Stand	Stand
QXXN2PT012ES06	QCXD11-F	Display	Stand	Stand
QXXN2PT018EQ04	QCXD11-FM	Display	Stand	Stand
QXXN2PT018ES06	QCXD11-M	Display	Stand	Stand
QXXN2PT024ES06	QCXD12-F	Display	Stand	Stand
QXXN2AT027ES06	QCXD12-FM	Display	Standard + PI	Standard + PI
QXXN2AT027ES06	QCXD13-F	Display	Standard + DF	Standard + DF
QXXN2AT027ES06	QCXD13-FM	Display	Standard +	Standard +
QXXN2AT027ES06	QCXD15-F	Display	Standard +	Standard +
QXXN2AT027ES06	QCXD15-FM	Display	Standard +	Standard +
QXXN2AT027ES06	QCXM11	No Display	Stand	Stand
QXXN2AT027ES06	QCXM11-F	No Display	Stand	Stand
QXXN2AT027ES06	QCXM11-FM	No Display	Stand	Stand
QXXN2AT027ES06	QCXM11-M	No Display	Stand	Stand
QXXN2AT027ES06	QCXM12-F	No Display	Stand	Stand
QXXN2AT027ES06	QCXM12-FM	No Display	Stand	Stand



Weight lbs (kg)	Length in (mm)	to center distance in (mm)	Voltage	Drive	Communications	Communication Type	Display Type
2.0 (0.91)	7.99 (203)	1.02 (26)	20V	3/8" Square	Via USB Cable	Via USB Cable	NO
2.0 (0.91)	7.99 (203)	1.02 (26)	20V	3/8" Square	Via USB Cable	Via USB Cable	YES
2.0 (0.91)	7.99 (203)	1.02 (26)	20V	3/8" Square	Via USB Cable	Bluetooth Only	NO
2.0 (0.91)	8.13 (206.5)	1.02 (26)	20V	1/4" Quick Change	Via USB Cable	Via USB Cable	NO
2.0 (0.91)	7.99 (203)	1.02 (26)	20V	3/8" Square	Via USB Cable	Via USB Cable	NO
2.0 (0.91)	7.99 (203)	1.02 (26)	20V	3/8" Square	Via USB Cable	Via USB Cable	YES
2.0 (0.91)	7.99 (203)	1.02 (26)	20V	3/8" Square	Via USB Cable	Bluetooth Only	NO
2.0 (0.91)	8.13 (206.5)	1.02 (26)	20V	1/4" Quick Change	Via USB Cable	Via USB Cable	NO
2.0 (0.91)	8.35 (212)	1.02 (26)	20V	3/8" Square	Via USB Cable	Via USB Cable	NO
2.0 (0.91)	8.35 (212)	1.02 (26)	20V	3/8" Square	Via USB Cable	Via USB Cable	YES
2.0 (0.91)	8.35 (212)	1.02 (26)	20V	3/8" Square	Via USB Cable	Bluetooth Only	NO
2.0 (0.91)	7.99 (203)	1.02 (26)	20V	3/8" Square	Via USB Cable	Bluetooth Only	YES
2.0 (0.91)	8.13 (206.5)	1.02 (26)	20V	1/4" Quick Change	Via USB Cable	Bluetooth Only	YES
2.0 (0.91)	7.99 (203)	1.02 (26)	20V	3/8" Square	Via USB Cable	Bluetooth Only	YES
2.0 (0.91)	8.35 (212)	1.02 (26)	20V	1/4" Quick Change	Via USB Cable	Bluetooth Only	YES
2.0 (0.91)	7.99 (203)	1.02 (26)	20V	3/8" Square	Via USB Cable	Bluetooth Only	YES
2.0 (0.91)	8.13 (206.5)	1.02 (26)	20V	1/4" Quick Change	Via USB Cable	Bluetooth Only	YES
2.0 (0.91)	8.35 (212)	1.02 (26)	20V	3/8" Square	Via USB Cable	Bluetooth Only	YES
3.7 (1.68)	21.7 (552)	0.68 (17.2)	20V	3/8" Square	Via USB Cable	Bluetooth Only	YES
3.7 (1.68)	21.7 (552)	0.68 (17.2)	20V	3/8" Square	Via USB Cable	Via USB Cable	NO
3.7 (1.68)	21.7 (552)	0.68 (17.2)	20V	3/8" Square	Via USB Cable	Via USB Cable	YES
3.7 (1.68)	21.7 (552)	0.68 (17.2)	20V	3/8" Square	Via USB Cable	Bluetooth Only	NO
2.0 (0.91)	7.99 (203)	1.02 (26)	20V	3/8" Square	Wireless + USB	Wireless + USB	YES
2.0 (0.91)	8.13 (206.5)	1.02 (26)	20V	1/4" Quick Change	Wireless + USB	Wireless + USB	YES
2.0 (0.91)	7.99 (203)	1.02 (26)	20V	3/8" Square	Wireless + USB	Wireless + USB	YES
2.0 (0.91)	8.13 (206.5)	1.02 (26)	20V	1/4" Quick Change	Wireless + USB	Wireless + USB	YES
2.0 (0.91)	7.99 (203)	1.02 (26)	20V	3/8" Square	Wireless + USB	Wireless + USB	YES
2.0 (0.91)	8.13 (206.5)	1.02 (26)	20V	1/4" Quick Change	Wireless + USB	Wireless + USB	YES
2.0 (0.91)	8.35 (212)	1.02 (26)	20V	3/8" Square	Wireless + USB	Wireless + USB	YES
3.7 (1.68)	21.7 (552)	0.68 (17.2)	20V	3/8" Square	Wireless + USB	Wireless + USB	YES
5.0 (2.27)	23.1 (586.1)	0.85 (21.6)	40V	1/2" Square	Via USB Cable	Via USB Cable	NO
5.0 (2.27)	23.1 (586.1)	0.85 (21.6)	40V	1/2" Square	Via USB Cable	Via USB Cable	NO
5.0 (2.27)	23.1 (586.1)	0.85 (21.6)	40V	1/2" Square	Via USB Cable	Bluetooth Only	YES
5.0 (2.27)	23.1 (586.1)	0.85 (21.6)	40V	1/2" Square	Via USB Cable	Bluetooth Only	YES
5.0 (2.27)	23.1 (586.1)	0.85 (21.6)	40V	1/2" Square	Wireless + USB	Wireless + USB	YES
5.0 (2.27)	23.1 (586.1)	0.85 (21.6)	40V	1/2" Square	Wireless + USB	Wireless + USB	YES



Ingersoll Rand driven by an entrepreneurial spirit and ownership mindset, is dedicated to helping make life better for our employees, customers and communities. Customers lean on us for our technology-driven excellence in mission-critical flow creation and industrial solutions across 40+ respected brands where our products and services excel in the most complex and harsh conditions. Our employees develop customers for life through their daily commitment to expertise, productivity and efficiency.



**Learn more at [www.ingersollrand.com](http://www.ingersollrand.com)**

©2023 Ingersoll Rand. PTL\_034\_10\_2021\_QXConnectSeries